

9701
WILSHIRE
BOULEVARD
Beverly Hills

ROAR

SUBLEASE

GOLDEN TRIANGLE
CLASS A OFFICE

DETAILS

9701 WILSHIRE BLVD BEVERLY HILLS, CA 90210

AVAILABILITIES

Suite 920 - 1,040 SF

Suite 930 - 4,313 SF

Combined SF - 5,353 SF

RATE

TERM

\$4.50/SF FSG Negotiable

- Coveted 90210 office building at the crossroads of Wilshire Boulevard and Roxbury Drive
- Striking city views over Beverly Hills and Los Angeles
- Exceptional proximity to the best retail, restaurants and amenities of the Golden Triangle
- 3 reserved parking spaces

LISTING TEAM

JAKE ZACUTO

Managing Director
310.469.9012
BRE #01377441

ANDREW SINASOHN

Executive Vice President
310.469.9023
BRE #01951740

GABE HISEM

Senior Director
231.631.2327
BRE #02187347

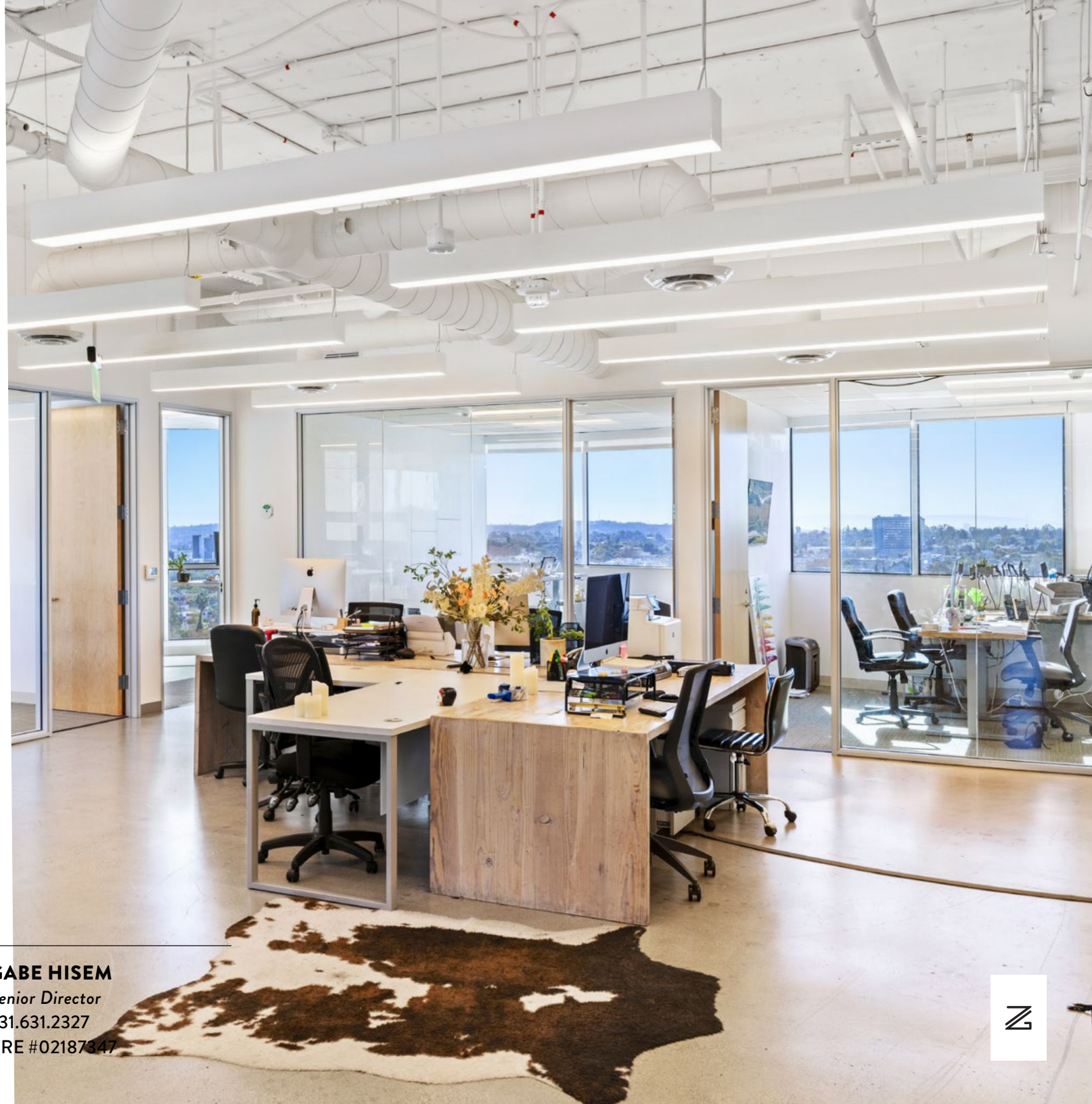

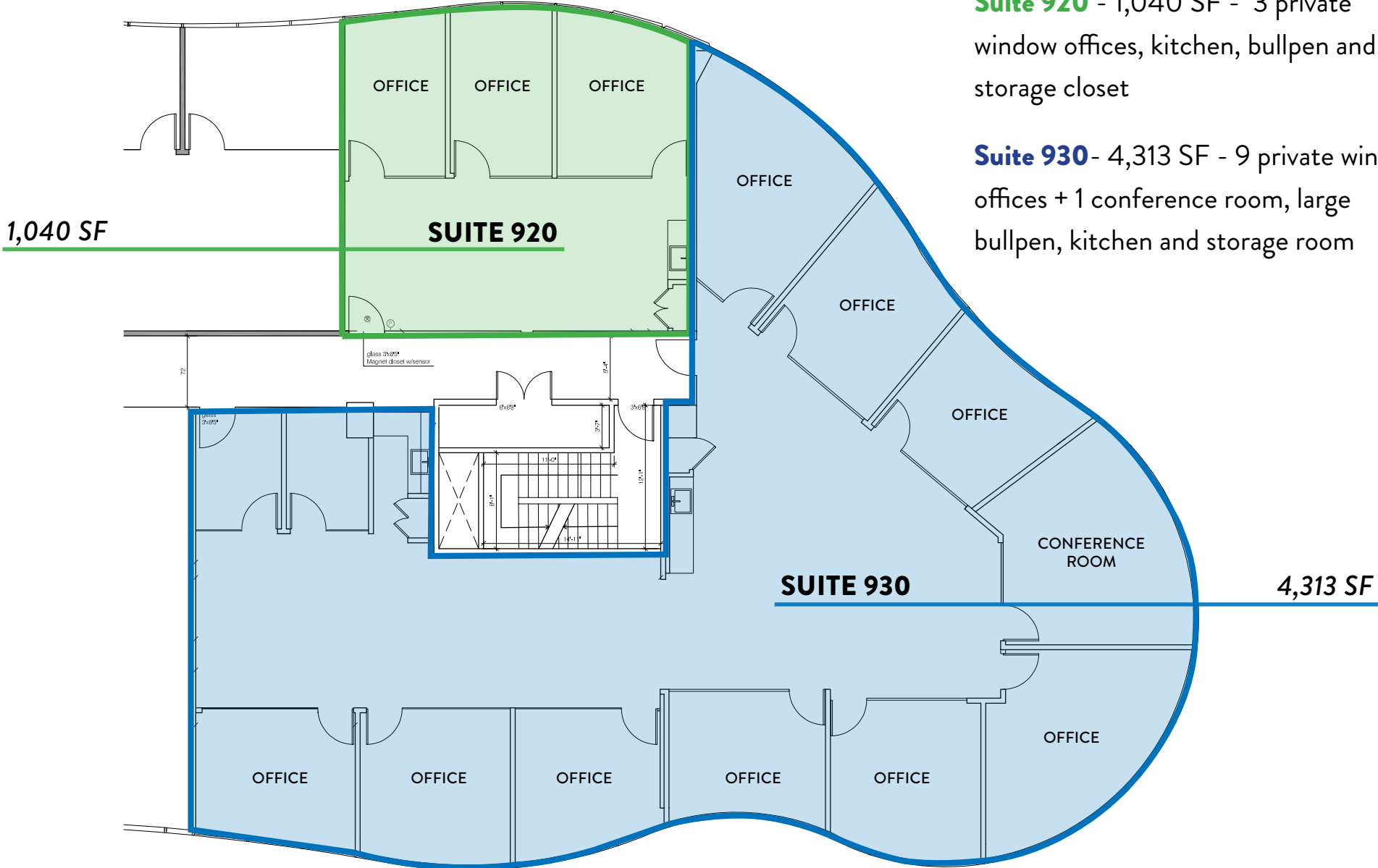

Suite 920 - 1,040 SF - 3 private window offices, kitchen, bullpen and storage closet

Suite 930 - 4,313 SF - 9 private window offices + 1 conference room, large bullpen, kitchen and storage room



SUBLEASE 9701 WILSHIRE BLVD, BEVERLY HILLS, CA 90210

FLEXIBLE LAYOUT

Mix of offices, conference rooms
and open bullpen space





ICONIC VIEWS

High floor suite with open city views of Beverly Hills and beyond





SUBLEASE 9701 WILSHIRE BLVD, BEVERLY HILLS, CA 90210

CITY National BANK

FILL THE SCHEDULE

9701
WILSHIRE
BOULEVARD
Beverly Hills





DOWNTOWN LA

WEST HOLLYWOOD

9701 WILSHIRE BOULEVARD
Beverly Hills

UTA

LIVE NATION

WALLY'S

IL PASTIAO

BURBERRY

WILLIAM MORRIS ENDEAVOR

MGM

HILLSTONE RESTAURANT GROUP

CANON DRIVE

RODEO DRIVE

HERMES

GUCCI

EQUINOX GYM

CRUSTACEAN

MR. CHOW

CITY NATIONAL BANK

NEIMAN MARCUS

SANTA MONICA BLVD

WILSHIRE BLVD

SPRING PLACE

THE GORES GROUP

WALDORF ASTORIA

PENINSULA HOTEL

IL CAFFÈ



📍 IL PASTAIO - CANON DRIVE



📍 CRUSTACEAN - N. BEDFORD DRIVE



📍 AVRA - N. BEVERLY DRIVE



📍 EREWHON MARKET - N. BEVERLY DRIVE



📍 ALFRED COFFEE - SANTA MONICA BLVD



📍 BEVERLY WILSHIRE HOTEL



9701 WILSHIRE BOULEVARD *Beverly Hills*



JAKE ZACUTO

Managing Director

310.469.9012

jake@zacutogroup.com

BRE #01377441

ANDREW SINASOHN

Executive Vice President

310.469.9023

andrew@zacutogroup.com

BRE #01951740

GABE HISEM

Senior Director

231.631.2327

gabe@zacutogroup.com

BRE #02187347

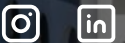

ZACUTOGROUP.COM | 310.469.9300

No warranty, express or implied, is made as to the accuracy of the information contained herein. This information is submitted subject to errors, omissions, change of price, rental or other conditions, withdrawal without notice. All parties who receive this material should not rely on it, but should use it as a starting point of analysis, and should independently confirm the accuracy of the information contained herein through a due diligence review of the books, records, files and documents that constitute reliable sources of the information described herein. Logos and images are for identification purposes only and may be trademarks of their respective companies. All terms provided are approximate. Lessee to verify. 11/2023